

Maintenance schedule Visatron VN/93

The routine maintenance schedule must be followed as described below. Valid for gas operation with TPS turbo charger, stationary power plant application and marine engines.

NOTE: All maintenance steps should be performed while engine is stopped!

	What to do:	Interval:	Part kit:
Procedure 1	<ul style="list-style-type: none"> Check the negative pressure with u-tube manometer or digital manometer. Adjust if necessary! Setting level is 60,00 mmH₂O! Replace the sintered bronze air filter/fresh air filter in the measuring head. Clean the fresh air bores in the measuring head. Use the cleaning needle. Clean both infrared sensor glasses in the measuring head with cotton pins and cleaning fluid. Perform functional test with test glass kit. 	Every 3 months or 2 000 engine running hours. (whatever comes first)	Filter kit VN/93 – Part no.:151490BU Cleaning kit – Part no.: 151482 U-tube gauge kit – Part no.: 270532 Test glass kit – Part no.: 11072
Procedure 2	<ul style="list-style-type: none"> Replace filter in pressure regulator. <p>If you have a water separator:</p> <ul style="list-style-type: none"> Replace filter cartridge of water separator. 	Every 6 months or 4 000 engine running hours. (whatever comes first)	Filter cartridge – Part no.: 273119
Procedure 3	<ul style="list-style-type: none"> Replace maintenance kit due to yearly inspection of general parts. Clean the OMD. Check performance of pressure regulator- replace parts if necessary! Clean suction pipes/ pipe system and siphon blocks with compressed air! Check scavenging air outlet behind the control cover manually (low-right) by feeling the air stream. 	Every 12 months or 8 000 engine running hours. (whatever comes first)	Maintenance kit VN115/93 – 100153-151489 Maintenance kit VN116/93 – 100154-151487 Maintenance kit VN215/93 – 100155-151488 Mounting system - Part no.: 10991
Procedure 4 This procedure is to be carried out by authorized service personnel only!	<ul style="list-style-type: none"> Inspection of complete OMD installation. Replace complete service kit on OMD. Clean the inside & outside of base plate. Check performance of pressure regulator- replace parts if necessary! Clean suction pipes/ pipe system and siphon blocks with compressed air! Perform functional test of entire oil mist detector system with smoke generator or smoke test. 	Every 24 months or 16 000 engine running hours. (whatever comes first)	Maintenance kit VN115/93 – 100153-151489 Maintenance kit VN116/93 – 100154-151487 Maintenance kit VN215/93 – 100155-151488 Smoke test kit – Part no.: 151780
Procedure 5 This procedure is to be carried out by authorized service personnel only!	<ul style="list-style-type: none"> Inspection of complete OMD installation. System to be modified and upgraded if necessary! Replace complete oil mist detector or measuring head with an exchange unit. Replace complete service kit on OMD. Clean the inside & outside of base plate. Check performance of pressure regulator- replace parts if necessary! Clean suction pipes/ pipe system and siphon blocks with compressed air! <p><i>If you are ordering a complete exchange oil mist detector unit, there is no need to replace maintenance kit for base plate.</i></p>	Every 48 months or 32 000 engine running hours. (whatever comes first)	Maintenance kit VN115/93 – 100153-151489 & exchange unit! Maintenance kit VN116/93 – 100154-151487 & exchange unit! Maintenance kit VN215/93 – 100155-151488 & exchange unit!

Procedure 1:



1. Check the negative pressure with a u-tube manometer. Adjust if necessary! Setting level is 60,00 mmWC!

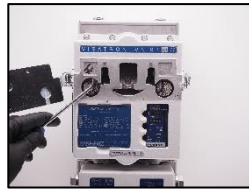

2. Replace the sintered bronze air filter/fresh air filter.

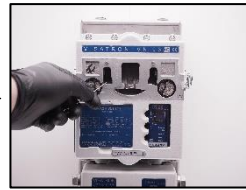

3. Clean the fresh air bones in the measuring head. Use the cleaning needle.



4. Clean the infrared sensor glasses at the left and the right side inside the measuring head. Use cotton sticks and cleaning fluid.

Procedure 2:



1. Close the air pressure.



2. Hold the filter cage in one hand and pull the blue tab down horizontally with your thumb.



3. Turn the filter cage clockwise and pull out downwards.

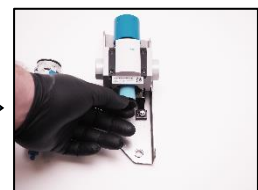

4. Unscrew the black plastic disc and remove the dirty filter.

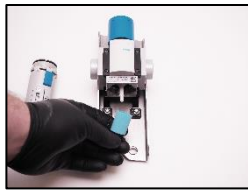

5. Screw in the new filter counter clockwise and make sure that it is aligned for installation.



6. Reinstall the filter cage.



7. Install the quick connection.



8. Fill in slacked water in the u-tube manometer.



9. To the middle line.



10. Install the u-tube manometer.

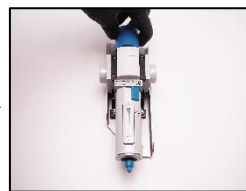

11. Adjust the air pressure to 60.00 mmWC!



12. Disconnect the u-tube manometer and install the plug for inspection cover.

Procedure 3:



1. Stop the engine and reduce the incoming air pressure.



2. Disconnect the RESET task connector.



3. Dismount the measuring head.



4. Disconnect the connection case.

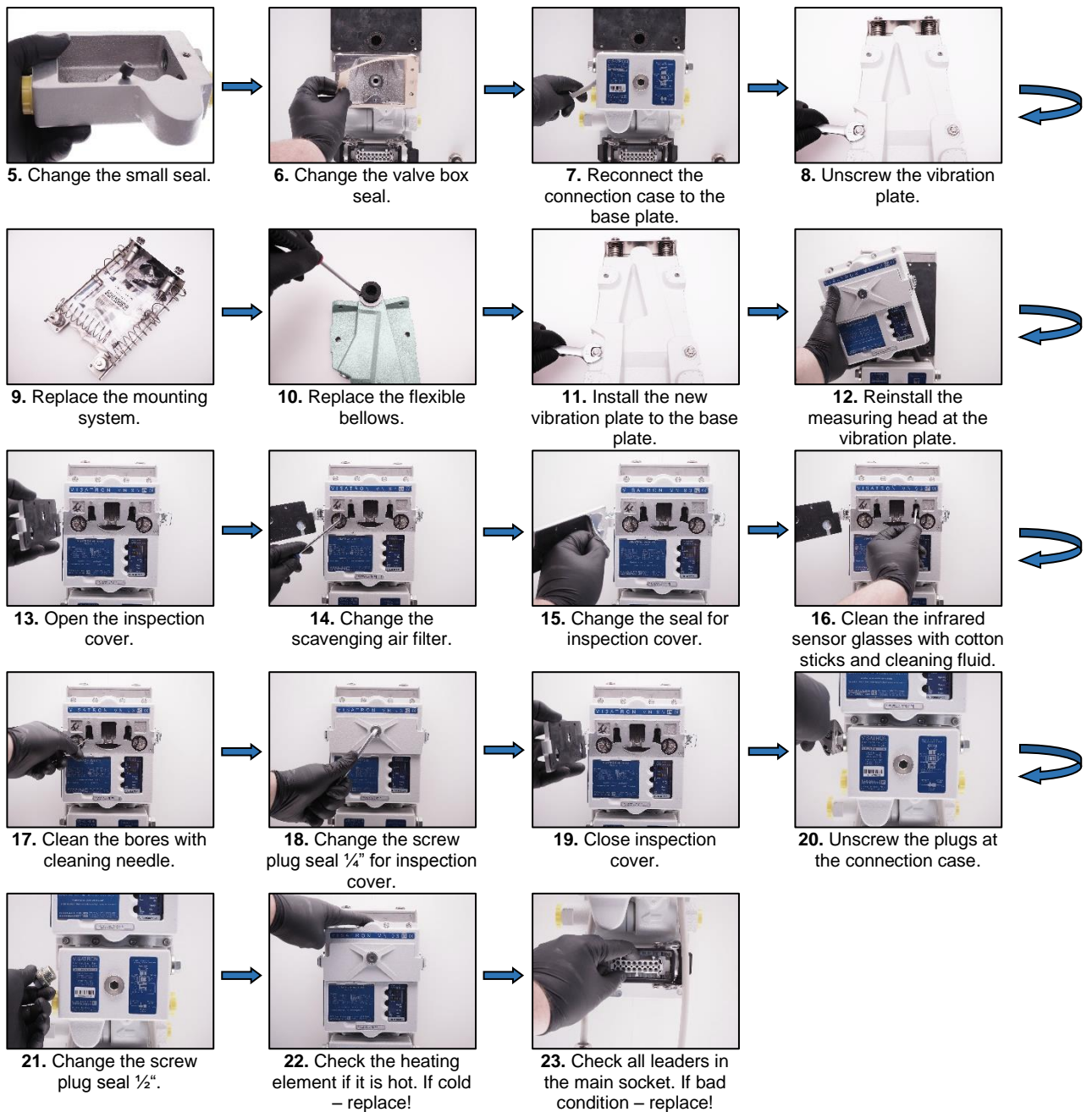

Procedure 4 & 5: This procedure is to be carried out by authorized service personnel only!

